

DG-18M. - 6t / 20 pax SUPPLY and CREW BOAT

Purpose / Description: This powerful multi-purpose crew & supply boat designed for the heavy duty works for crew and supply transfers, mooring and towing of ships with limited to it's capacity. Alternatively capable also for pollution control, recovery operation, diving survey facilities. The boat is designed and equipped with high quality marine components and equipments for operation within coastal area. Sea keeping capability up to sea state -7 (bf-9).

Specifications:

Length (LOA)	: 18.50 metres
Length (LWL)	: 16.80 metres
Beam (moulded)	: 5.60 metres
Depth to main deck (moulded)	: 2.70 metres
Draft (maximum)	: 1.70 metres
Displacement tonnage	: 80.00 tons
DWT capacity	: 30.00 tons

Classification Society and Certificates:

BV or RINA
I + HULL + MACH SUPPLY & CREW BOAT
COASTAL AREA

Propulsion and Main Engine:

2 x 360 kW diesels at 1800-2100 rpm
2 x 4-blade FPP propeller dia appx. 1100 mm

Auxiliary engines :

1 x 20 kW diesel generators

Speed, Performance & Range:

Service Speed (%70MCR)	: 12.00 knots
Maximum Speed	: 15.00 knots
Bollard pull (at zero speed)	: 6.0 tons
Range (at service speed)	: 500 n. miles

Passenger capacity :

1 x Passenger salon with seats : 18 seats

Cargo capacity :

1 x cargo hold	: 18 cubic meters
Deck area, strengthened for 0,6 t/m2 hom-loads	: 35 square meter
Total cargo capacity	: 15 tons

Tank Capacities:

Fuel	: 8000 litres
Freshwater	: 2000 litres
Clean Oil	: 200 litres
Hydraulic Oil	: 100 litres
Dirty oil	: 200 litres
Bilge	: 300 litres
Sewage	: 1000 litres

Deck Equipment:

Hydraulic anchor windlass with capstan	
Towing bit: 1 x SWL 6.0 ton	
Towing and mooring capstan (aft deck)	: 1 x SWL 2.0 ton
Telescopic, knuckle type hyd. crane	: SWL 3,0 ton at 4.5 m SWL 1,0 ton at 9.5 m
Bollards and chocks	: 6
Forward towing bit	: 1

Others :

M-Engine are 24DC battery start & aut-charge
Shore connection with auto-battery charging
Jel type batteries sets (for M/E, serv, gen) : 3 groups
International shore connections
General alarm
Bilge and tank level alarm and monitoring

Fender System :

Fenders to be "W" type rubber on bow and stern corners
Tires or "D" type rubber on sides.

External Fi-Fi Equipment (optional) :

Electrical driven fire pump	: 1 x 200 kW at 6 bar
Fire monitor (remote or manual)	: 2 x 100 m3/h
Fire hydrants	: 2 x sets

Accommodation:

1 cabin with three berths for crew
Daily living room with TV
Galley (refrigerator, plate heaters, basin)
2 x WC and shower facility (one main deck for pax, other for crew)
Wheelhouse 360 deg visibility
1 passenger salon with 18 seats
Heating by hot water circulation
Chillers type A/C with sep fan coils, cooling/heating in all areas
24 DC fans for ventilation of each cabin
24 DC reversible fans for Engine room

Navigation Equipment:

Radar 48 nmiles (combined chart plotter and GPS)
Magnetic Compass
dGPS & Plotter
AIS, Navtex
Auto-pilot with satellite compass (optional)
Echo sounder
SART, EPIRP
1 x Searchlight 500 w (remote)
Navigation lights
Horn / Siren

Communication Equipment:

1 x UHF/MF Radio with DSC – 150w (Optional)
1 x VHF / FM (DSC) 25w
1 x handy VHF-GMDSS radio 2w
Intercom & announce system
CCTV system (engineer room, aft, both salons)

Internal Fi-Fi and Life Saving Appliances:

2 x 12 capacity inflatable life rafts
Life jackets and buoys
Fire alarm system
Fixed CO2 system for Engine room

General Specifications:

Longitudinal system welded steel construction
One continuous deck with step
Raised bow
High seaworthiness and manoeuvrability
All navigation and illumination is 24 DC volt
360 deg visibility at wheelhouse with heated windows defogging
Wipers heavy duty type-for wheelhouse
Monitoring and alarm system for engineer room

OPTIONAL Systems :

Nozzle system with multi-blade rudders for propeller(s)
Increasing of bollard pull capacity up to 18 tons acc M/Es power
Increasing speed up to 18 knots acc to M/Es power
RHIB boat for 4 persons and outboard motor
Air compressors and reservoir



DÜZGİT
GEMİ İNŞA SANAYİ A.Ş.

DG-18M. - 6V/20 PAX

SUPPLY and CREW BOAT

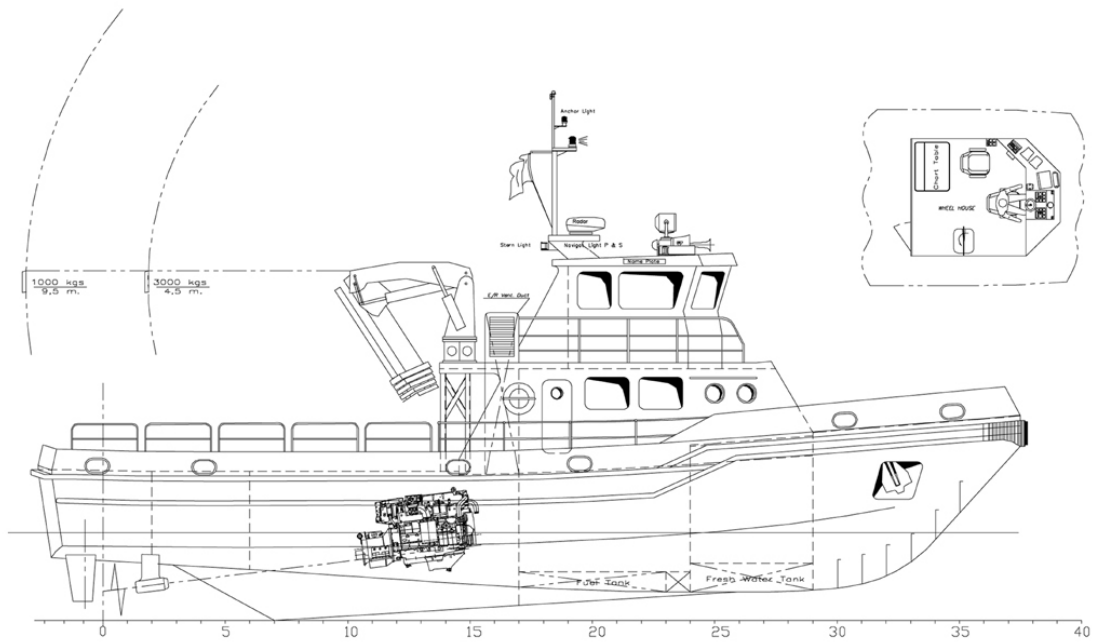

PROFILE

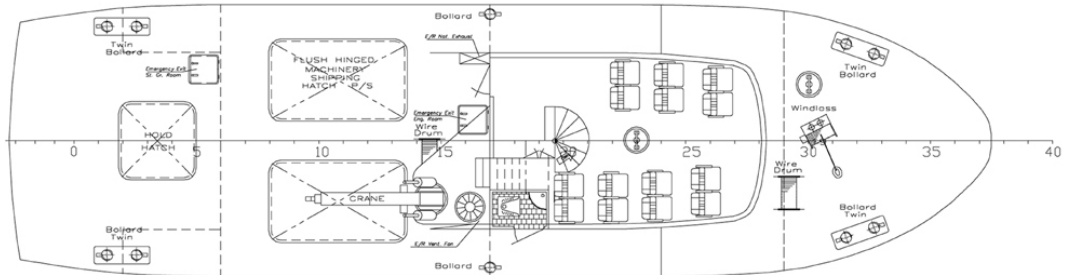

MAINDECK

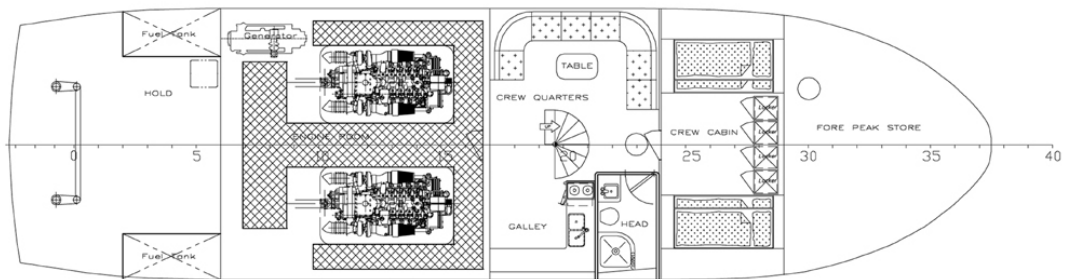

TANK TOP

- PARTICULARS -

LENGTH (OAL)	: 18.5 m.
LENGTH (WL)	: 16.8 m.
BEAM (MLD)	: 5.6 m.
DRAFT (MLD)	: 1.6 m.
DRAFT (MAX)	: 1.7 m.
DRAFT (LOADED)	: 2.0 m.
SPEED service	: 12.5 k knots
CREW	: 3
PASSENGER	: 18 persons

IMPORTANT NOTE

All rights of this project and drawings shall be a property of Düzgıt Ship Construction and any violation without the written permission of Düzgıt Ship Construction shall be considered a criminal offense.

CREW & SUPPLY BOAT



DESIGNED BY	OWNER	SHIPYARD	SHELL NR
CHECKED BY			
CAD/CALC			
CLASS	SCALE	DATE	PROJECT NR DRAWINGS